

# Tröst Lite

Adjustable Long-Term Care Bed

Owner's Manual



**permobil**

Version 1.0 December 2023 © Permobil 2023

This document may not be reproduced, copied or used for purposes other than its intended use without the prior written consent of Permobil.

This manual includes installation instructions as well as important safety and maintenance information for your Tröst Bed.

All information, pictures, illustrations and specifications are based upon the product information available at the time this manual was created.

The information in this document is subject to change without notice.

ALL RIGHTS RESERVED

## Technical and Customer Support

In the event of problems, contact your dealer or call  
Permobil Canada 1-800-265-9830.

Be prepared to provide the bed serial number.

Spare parts and accessories may be ordered through your dealer.

### Permobil Canada

2215/2221 46e Avenue • Lachine QC H8T 3C9

Tel.: 800-265-9830 • Fax: 877-636-8944

[www.permobil.ca](http://www.permobil.ca)

### Permobil North American head office

300 Duke Drive • Lebanon TN 37090

Tel: 1-800-736-0925 • Fax: 1-800-231-3256

[www.permobilus.com](http://www.permobilus.com)

### Permobil group head office

Permobil AB

Box 120 • 861 23 Timra • Sweden

Tfn: +46 60 59 59 00

Fax: +46 60 57 52 50

E-mail: [info@permobil.se](mailto:info@permobil.se)

[www.permobil.com](http://www.permobil.com)

# Table of Contents

<b>Introduction</b>	<b>1</b>
Design and Functions .....	1
Specifications.....	2
Safety Precautions.....	3
<b>Bed Assembly</b>	<b>4</b>
Overview .....	4
Inspection before unpacking .....	4
Damage during transport .....	5
Incorrect shipment.....	5
1 – Unpack the bed .....	6
2 – Assemble the platform.....	9
2.1 Remove cable ties.....	15
2.2 Remove the hardware pack .....	18
2.3 Test the bed positions.....	19
3 – Install optional side rails.....	20
3.1 Install tall rails or half side rails .....	20
3.2 Install full side rails.....	24
3.3 Install optional assist bar .....	29
4 – Install the headboard and footboard .....	32
4.1 Install the headboard and footboard.....	32
5 – Connect the optional staff controller.....	35
6 – Install the battery backup.....	38
7 – Prepare the bed for use .....	41
7.1 – Install the optional length extender .....	41
7.2 – Install mattress retainers .....	42
7.3 – Use the bumper bar .....	43
7.4 – Use the wheel directional limiters.....	43

<b>Optional Transport Trolley Assembly</b>	<b>44</b>
Assemble the transport trolley.....	44
Use the transport trolley.....	48
<b>Bed Usage</b>	<b>51</b>
Inspect the bed before use .....	51
Move the bed into different positions.....	52
Safe operation .....	52
Moving the bed .....	52
Using side rails.....	53
User safety.....	53
Electrical safety .....	53
Maintenance .....	54
Cleaning.....	54
Regular inspection .....	54
Troubleshooting .....	55
Warranty.....	57
Returns .....	57

# Introduction

## Design and Functions

The Tröst Lite Bed is an electric adjustable bed designed for long-term care settings.

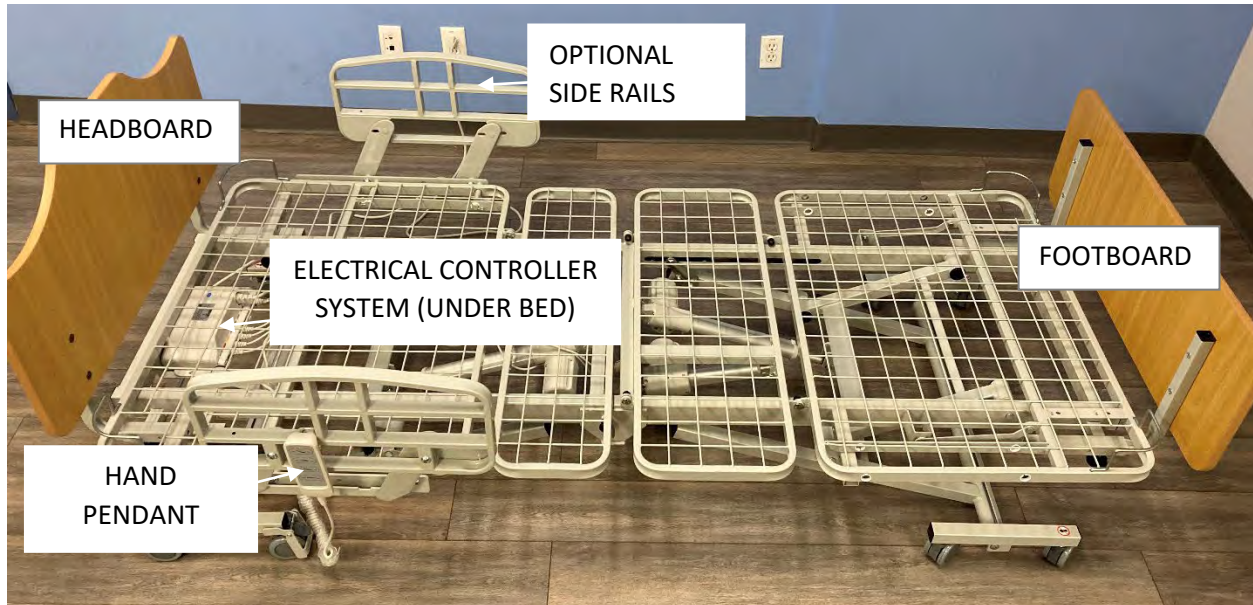

The Tröst Lite Bed includes

- platform
- headboard and footboard
- electrical controller system
- hand pendant
- assembly hardware
- mattress retainers

The following optional parts are available at an additional cost:

- length extender
- half side rails
- tall side rails
- full side rails
- assist bar
- staff controller
- battery backup
- transport trolley

The platform disassembles into 2 parts for easy assembly, transport and storage.

## Specifications

**Size:** 36" W x 80" L (91 cm W x 203 cm L) with optional 4" (10 cm) length extension (80"-84" [203 cm – 213cm])

**Weight capacity:** Up to 500 lbs (226 kg).

**Platform position:** low: 7.3" (18.5 cm); high: 28.3" (71.9 cm)

**Maximum Back Angle:** 65 degrees  $\pm$  3 degrees

**Maximum Knee Angle:** 30 degrees  $\pm$  3 degrees

**Electrical:** 120V, 60 Hz

Additional electrical specifications are indicated on the motor.

## Safety Precautions

Read and follow all instructions and warnings in this manual before assembling and using the bed. Incorrect assembly or use may injure the user or damage the bed.

Permobil is not responsible for personal injuries or property damage resulting from any person's failure to follow the warnings and instructions in this manual.

Permobil is not responsible for injuries or damage resulting from failure to exercise good judgment.

The final selection and purchasing decision about the type of electric bed to be used is the responsibility of the user and his or her healthcare professional. Permobil is not responsible for inappropriate selections of models or features or improper mountings on the bed.

The safe weight capacity for this bed is in the specifications section in this manual. Operation of the bed by users and equipment that exceeds the maximum allowable weight can lead to personal injury and property damage, including damage to the bed, as well as voiding any warranty applicable to the bed.

The Tröst Lite Bed should not be used in the presence of flammable anesthetic gas mixed with air, oxygen, or nitrogen oxide.

# BedAssembly

## Overview

The Tröst Lite Bed is designed for easy assembly, disassembly, and transport.

Two people are required to safely unpack the bed and put the bed together.

The general steps are as follows:

- 1 - Unpack the bed
- 2 - Assemble the platform
- 3 - Connect the electrical systems
- 4 - Install optional side rails or assist bar, if using
- 5 - Install the headboard and footboard
- 6 - Install optional staff controller, battery backup, or length extender, if using
- 7 - Install mattress retainers

Instructions for each of these steps are included in this manual.

**Tools required:** cable tie snippers, Allen keys, ratchet set (for optional half side rails only), Phillips head screwdriver, small hammer, cable ties

## Inspection before unpacking

Your bed will arrive in 3-4 separate boxes, depending on the optional items included:

- Platform, including electrical controller and hardware pack
- Headboard and footboard
- Optional side rails, assist bar, backup battery, staff controller, or length extender



## Damage during transport

Check your shipment to ensure that the Tröst Lite Bed or accessories have not suffered transport damage. It is the responsibility of the receiver to check the shipment. If damaged, there is a risk that the bed and its accessories can no longer be used safely and securely. Contact your dealer or Permobil for further information.

If there is any damage, it must be indicated on the bill of lading. Permobil must be informed of the situation within 24 hours of receipt of goods so that the carrier can be notified as soon as possible. If Permobil is not informed within 24 hours or the damages are not indicated on the bill of lading, the customer may have to pay all the costs incurred to replace or repair the damaged product.

## Incorrect shipment

If a Permobil product does not match the original order invoice, the problem must be communicated to Permobil within 48 hours of the time of delivery. Then, actions necessary to correct the situation will be at Permobil's expense and will be made as soon as possible, following the notification of the incorrect shipment.

## 1 – Unpack the bed

Two people are required to safely remove the bed from the skid and put the bed together.

The platform is shipped in 2 pieces in the same box:

- Head platform with electrical controller system
- Foot platform with hardware pack

All pieces are secured to a bracket on the packing skid.

**Tool required:** 6 mm Allen key

### STEPS

- 1 - Identify the box that contains the bed.
- 2 - Remove the outer box by slowly lifting it up. Protective inserts could fall out if the box is not removed carefully.
- 3 - Remove corner protectors and outer wrap. Leave tie-wraps in place.  
Note that the bed is attached to a bracket on the packing skid.

There is a box of hardware packed inside the foot platform. This box will be removed later in the assembly process.



- 4 - From the side of the packing skid, unscrew the wing nuts on each side of the head platform (the one with the controller attached) to unfasten the platform from the packing brackets. There are 2 wing nuts on each platform.

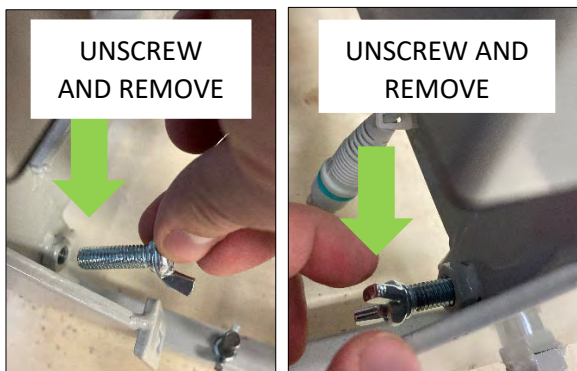
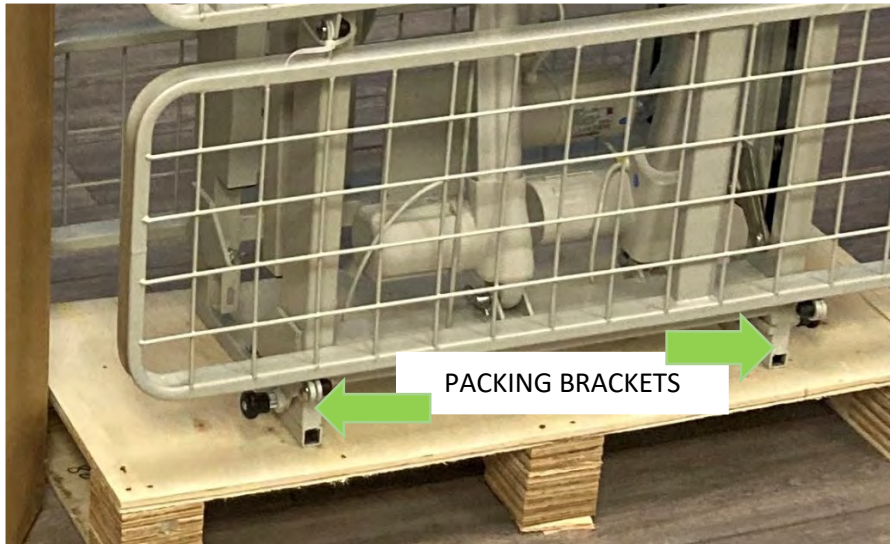

- 5 - Pull and twist the black knobs securing the platform to the packing bracket to unpin the knobs. There are 2 knobs to unpin on each side of the platform.



- 6 - One person must hold the platform that is still secured to the skid upright while a second person lifts the unsecured platform assembly off the packing support and places it wheels down on the floor.



- 7 - Repeat steps 4 and 5 to unfasten the other platform assembly from the packing bracket. Lift the second assembly up off the skid and place it wheels down on the floor.

## Packing Materials

After removing the bed assemblies, you will have a skid with 2 supports attached, and 4 loose bolts with wing nuts that are not needed to assemble the bed. It is recommended to store these packing materials so that you can securely store and transport the bed if necessary.

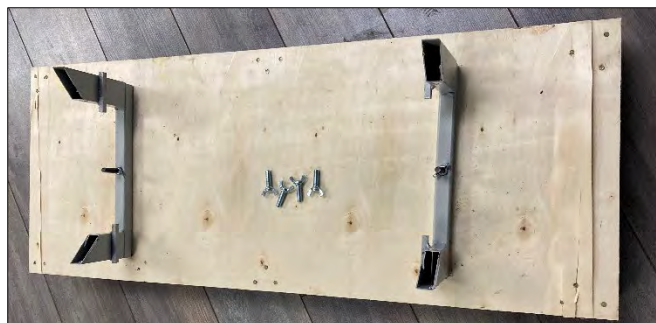



## 2 – Assemble the platform

The Tröst Lite Bed platform is provided in 2 pieces. You will arrange the head and foot platforms on the floor and then attach them in the middle.

Two people are needed for platform assembly.

### STEPS

- 1 - Arrange the head and foot platforms on the floor as shown below.



2 - Lock the foot end wheels by sliding the locking clip down on each wheel.



3 - Note the location of yellow and green connectors under the platform.



4 - Connect the yellow wire from under the head platform to the corresponding wire under the foot platform. Ensure that the arrows are aligned, and then close the cover.



5 - Connect the green wire from under the head platform to the corresponding wire under the foot platform. Ensure that the arrows are aligned, and then close the cover.





6 - Pull the black knobs on the foot platform out and twist them so they stay in the out position.

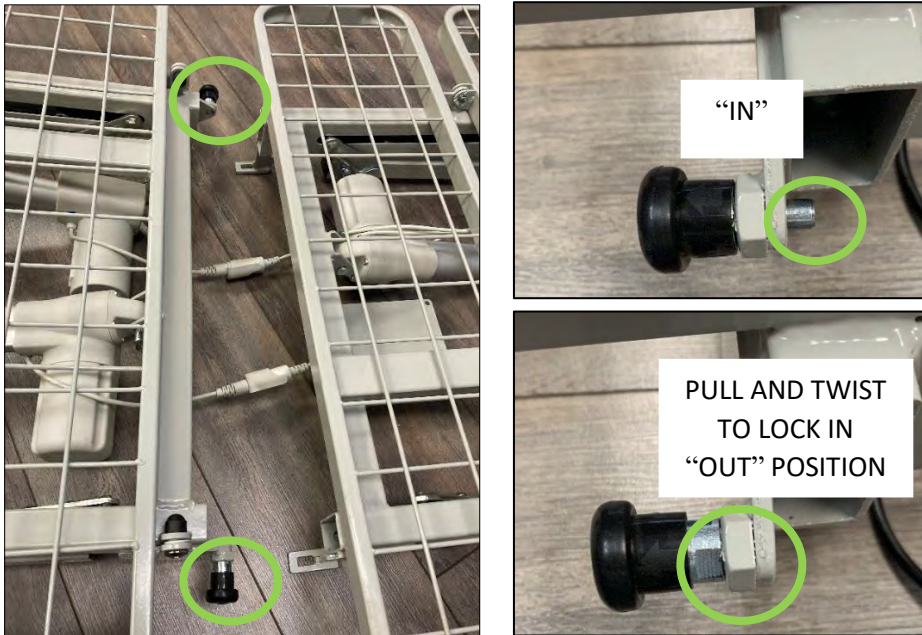

7 - With the black knobs in the out position, two people need to lift the middle of the platforms so that you can place the locking inserts on each side of the foot platform into the corresponding slots on the head platform.

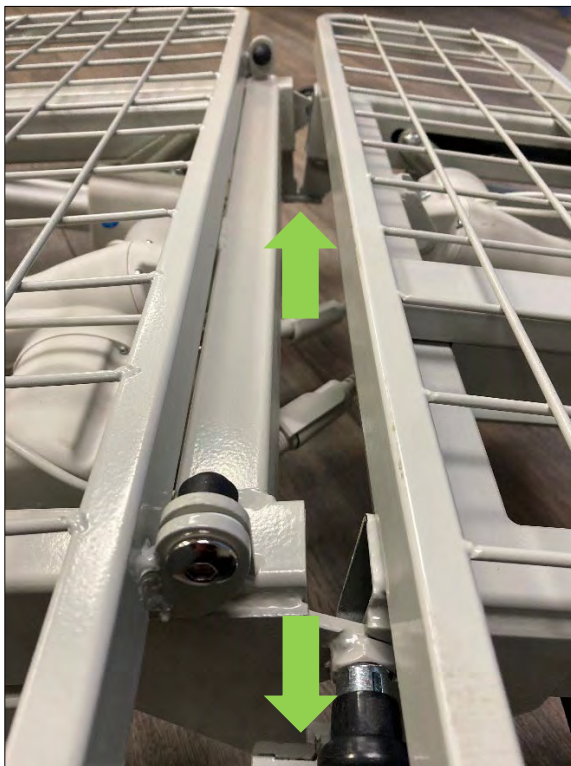



8 - Ensure that each locking insert is in position in the slot as shown below.

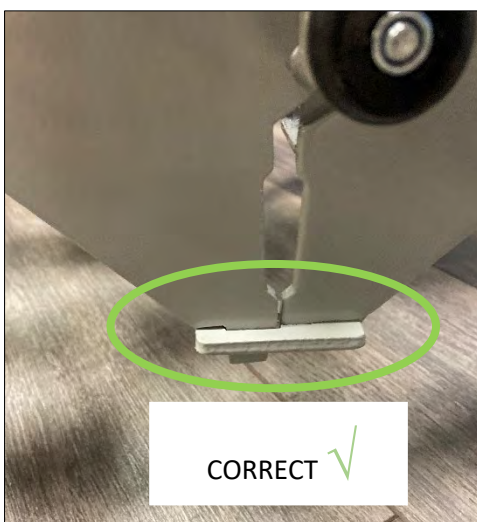
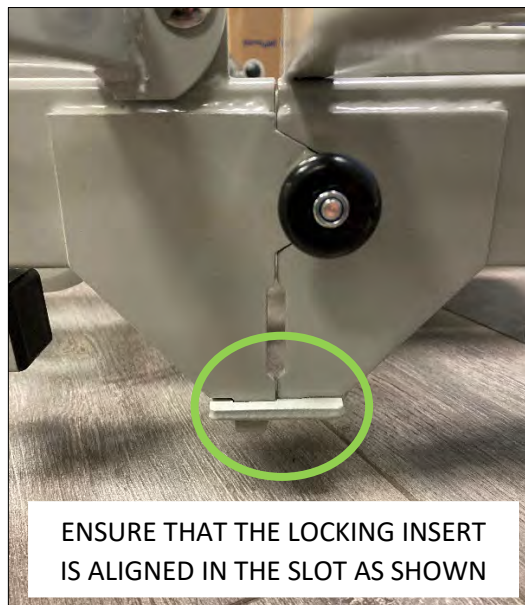
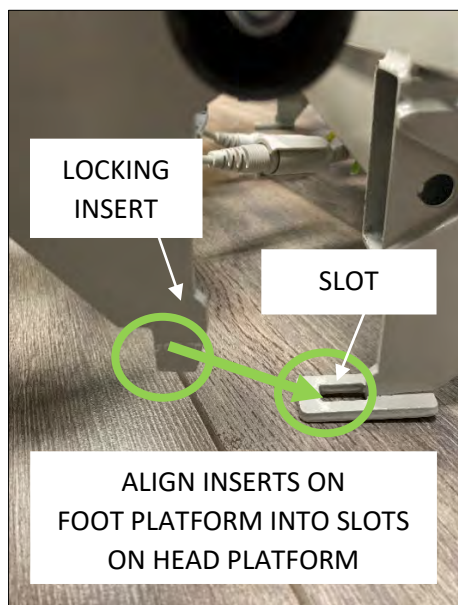

- 9 - Rotate the black locking knob to the “IN” position to secure the locking insert in place. Repeat on the other side of the bed. Ensure that the locking inserts are secured in place on each side.

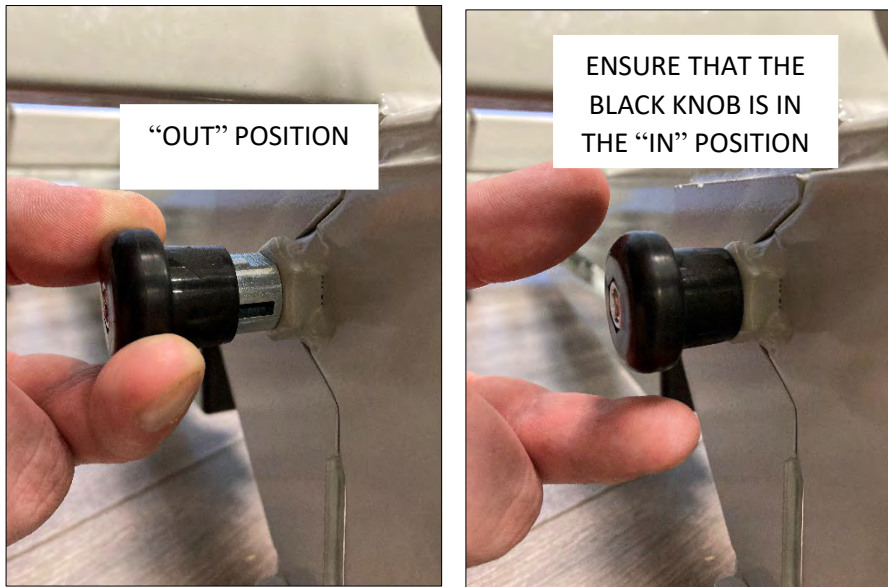

- 10 - Ensure that the platforms are secured together and the bed is flat.





## 2.1 Remove cable ties

Note that some cable ties should stay in place to secure the wires.

The cable ties listed below should be removed.

**Tool required:** cable tie snipper, box cutter to open hardware pack

### STEPS

- 1 - Cut 2 cable ties on the head deck so that you can lift the head deck.
- 2 - Lift the head deck so you can access the power cord and hand pendant. One person must hold the head deck in position.



- 3 - Cut the cable tie on the power cord.
- 4 - Cut the cable tie(s) on the hand pendant.

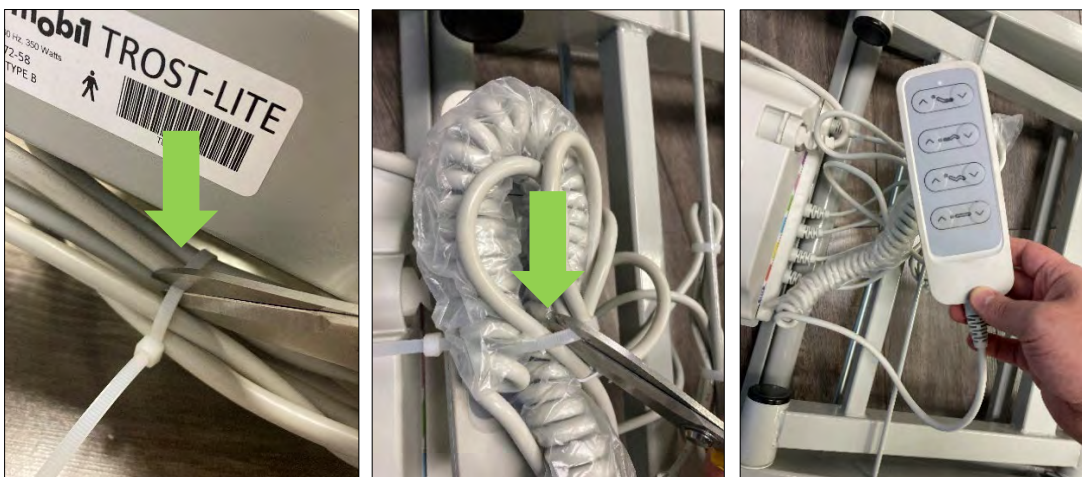

5 - Move the hand pendant and power cord aside and then lower the head deck.



6 - Cut the 2 cable ties in the knee area of the foot deck.

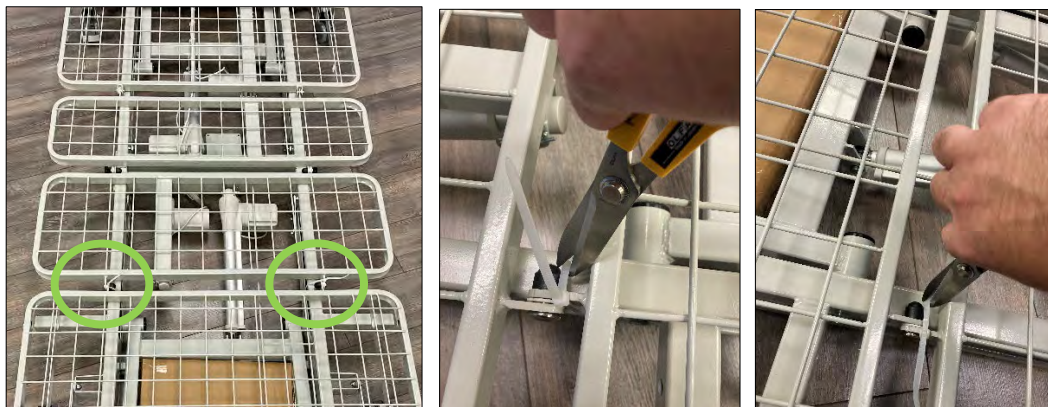

7 - Cut the 2 cable ties on the end of the foot deck.





- 8 - Remove the cap from the power plug and then plug the bed in to an appropriate power outlet. A green light will illuminate on the controller system under the bed when the power is on.



## 2.2 Remove the hardware pack

The hardware pack contents will be used later in the assembly process. Now that the electrical controller is connected to power you will be able to raise the bed and remove the hardware pack.

### STEPS

- 1 - Use the hand pendant to raise the bed enough so that you can remove the hardware pack.



## 2.3 Test the bed positions

Use the hand pendant to test all bed positions.

In general, the buttons on the left raise, and the buttons on the right lower each section of the bed.

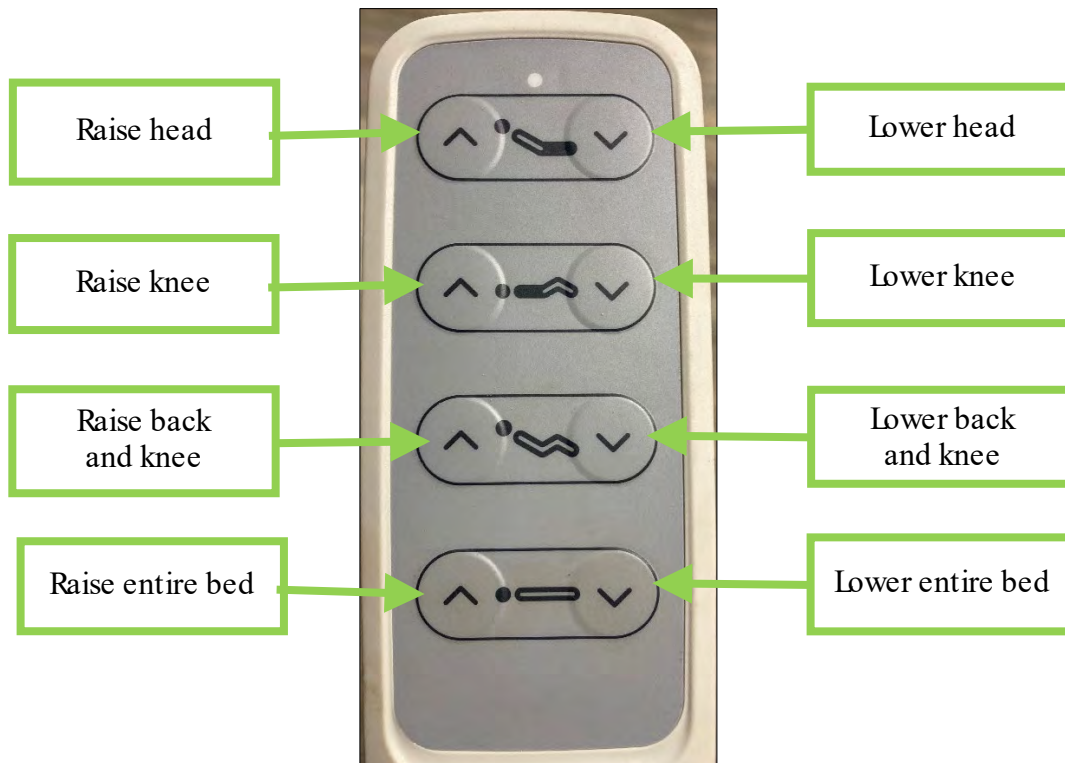

When finished, hang the hand pendant on the bed using the hook on the back of the hand pendant.



### 3 – Install optional side rails

There are 4 types of optional side rails available for the Tröst Lite Bed:

- Tall rails
- Half rails
- Full rails
- Assist bar

Side rails are shipped in a separate box.

#### 3.1 Install tall rails or half side rails

Tall rails and half side rails can be installed at the head or foot of the Tröst Lite Bed. Both tall and half side rails have the same installation instructions.

**Tool required:** Allen key

#### STEPS

- 1 - Open the side rail box and remove the side rails and hardware.





- 2 - Remove the packaging from the side rails and hardware.  
 Verify that you have 2 side rails, 4 screws, 8 pins, and 4 rods.

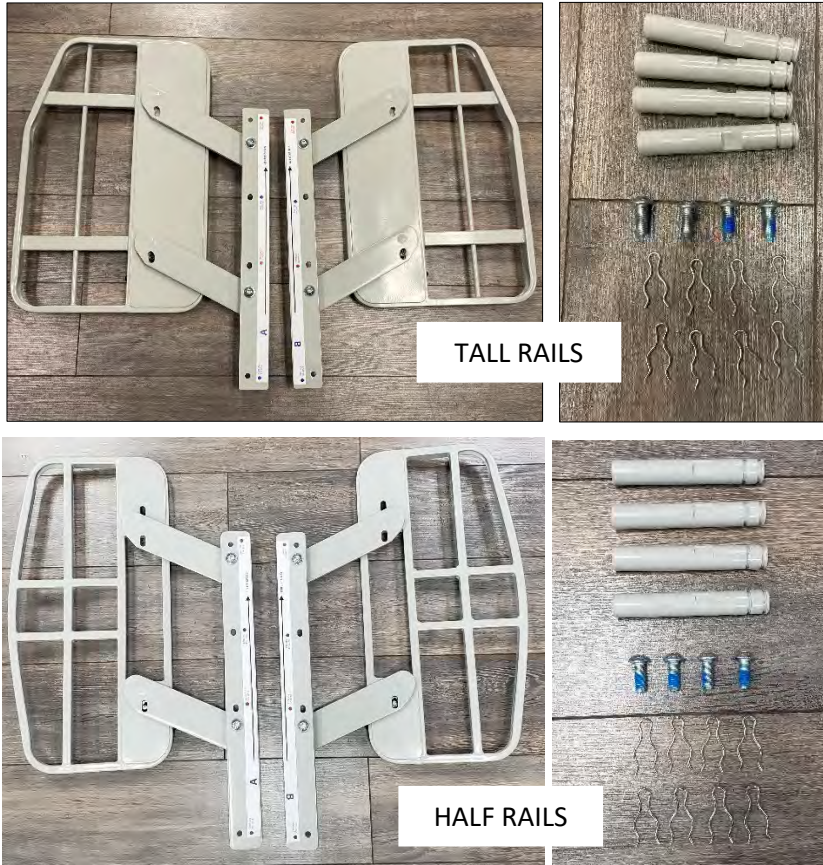

- 3 - Note the alignment indicator stickers on the inside of each side rail. Position the side rail so the sticker is facing in toward the bed, and the arrow pointing to the center of bed is pointing to the center of the bed. You may place the rails at either the foot or head end.

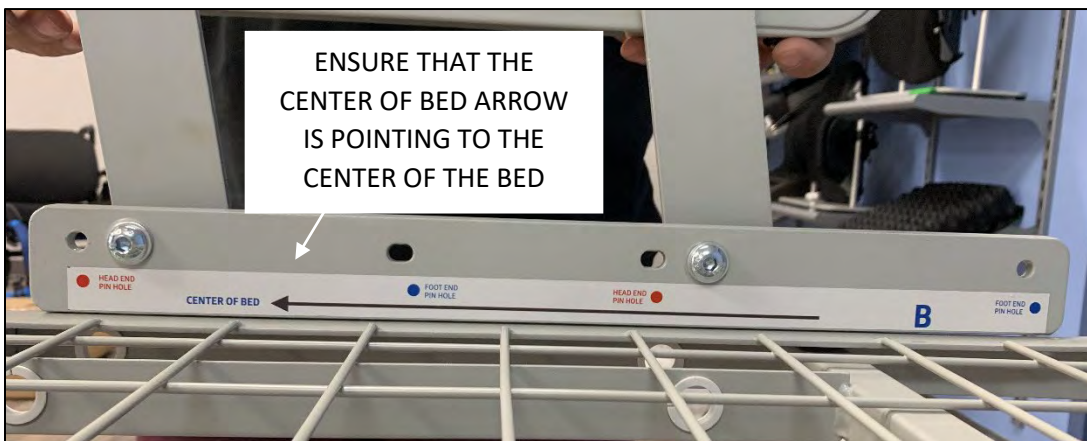

- If you are placing the rail on the head end you will use the head end holes indicated.
- If you are placing the rail on the foot end you will use the foot end holes indicated.

- 4 - Insert one screw from the outside of the rail through one of the holes you will be using. Use an Allen key to secure a rod to the screw from the inside of the rail.



- 5 - Repeat for the other hole so you have two rods secured to the inside of the rail.
- 6 - Feed the rods on the side rail through both the outside and inside holes on the bed.

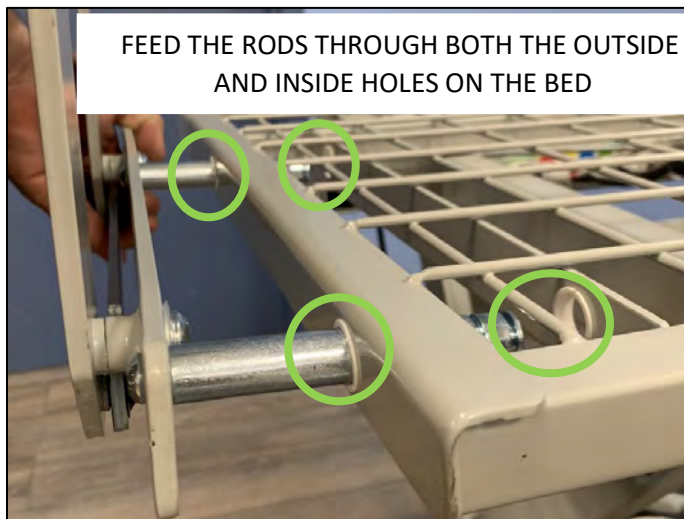

- 7 - Place a pin on each of the 2 grooves at the end of each rod to secure the rod in place. Be sure that there is one pin on each side of the frame hole as shown

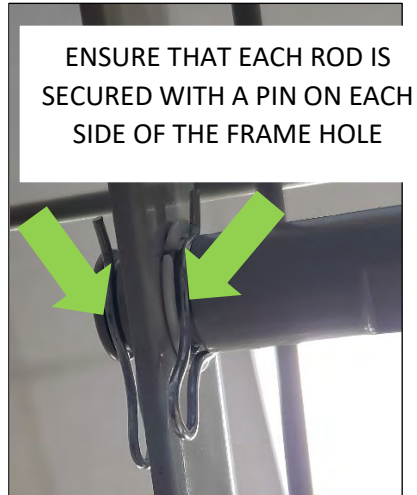
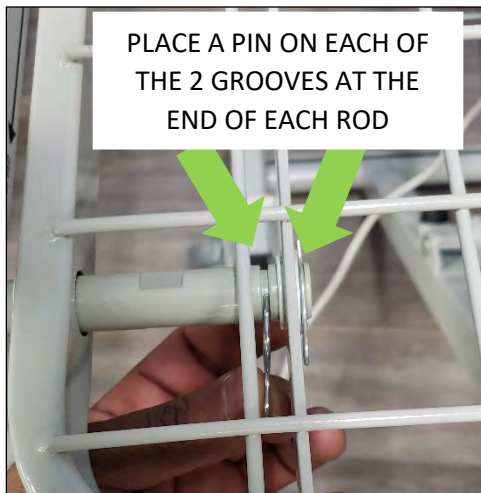

- 8 - Repeat for the half side rail on the other side of the bed, and for additional half side rails on the same side of the bed, if applicable.

To move the slide rail, press the black unlocking clip. The rail snaps in place when it's fully down.





### 3.2 Install full side rails

**Tool required:** an Allen key is provided

#### STEPS

- 1 - Open the full side rail box and remove the side rails and hardware.



- 2 - Remove the packaging from the side rails and hardware.  
Verify that you have 2 full rails, 4 washers, 4 screws, 4 spacers, 4 set screws, an Allen key and 4 rods.





- 3 - Look at the rails, bed and images below for an overview of how the rails fit.  
The curved side of the foot end will face toward the bed.

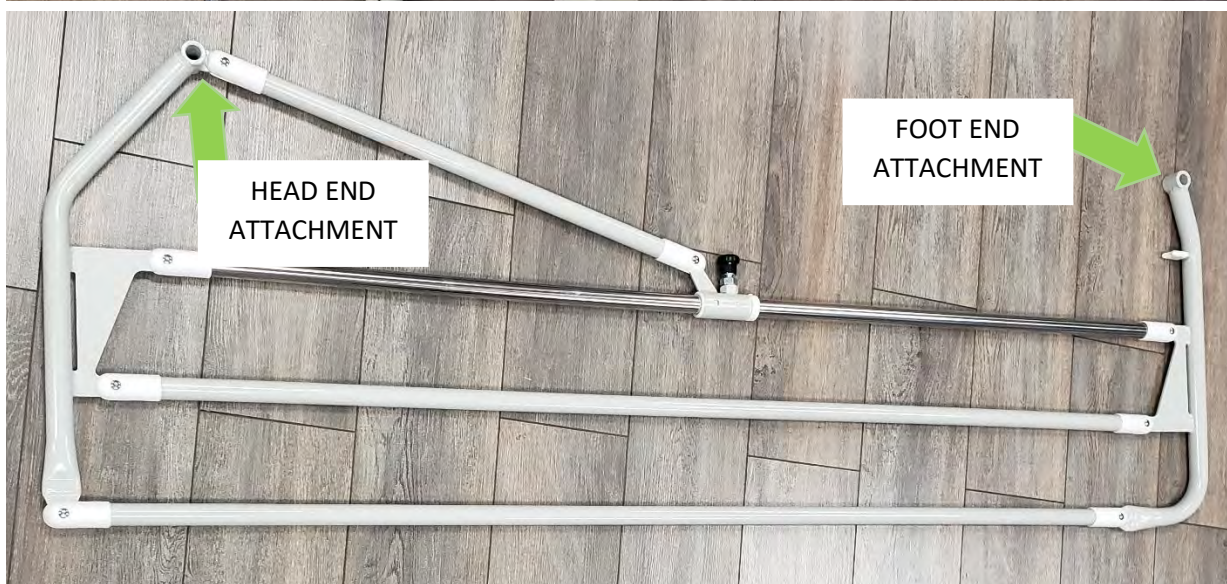
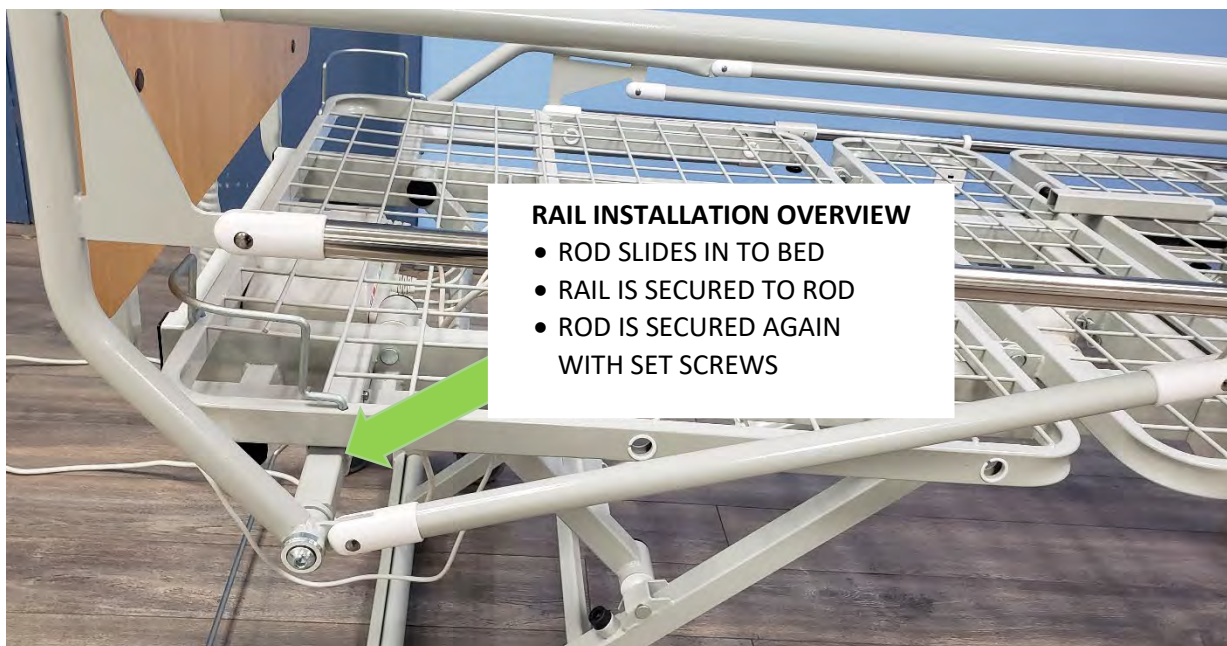

4 - Fit the square end of each rod into the ends of the bed at the attachment locations shown below. Press and hold the button on each rod as you feed it in so that the button engages in the middle hole.

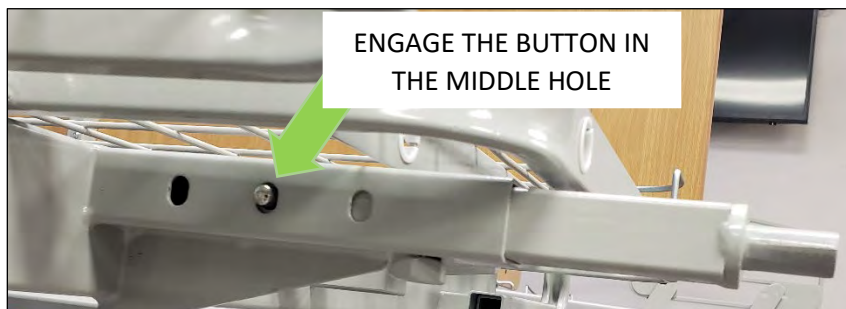
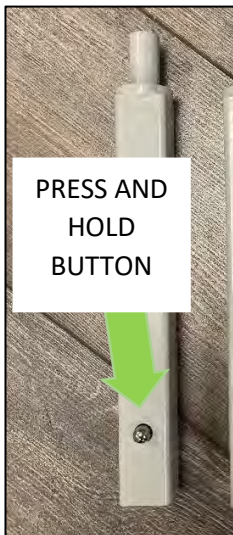
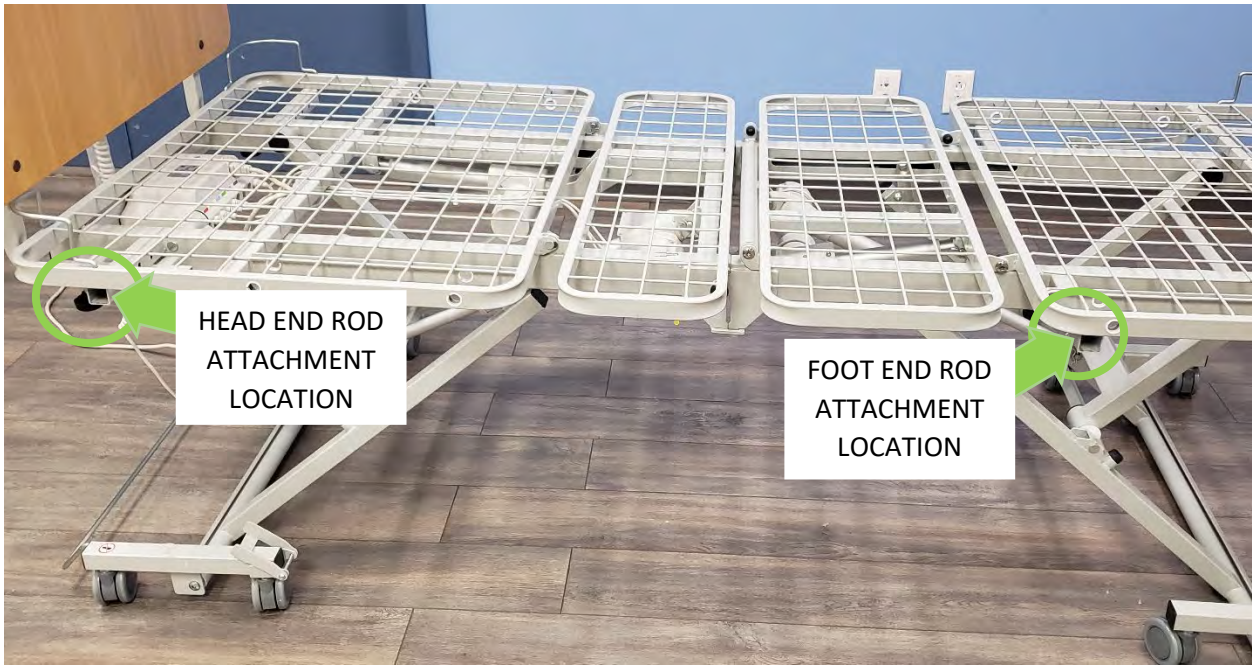



5 - Prepare a screw, spacer, and large washer.



6 - Align the rail next to the bed so that the correct attachment location is aligned with the correct rod. Use the screw, spacer and washer to fasten the rail to the rod. Tighten using the Allen key provided.

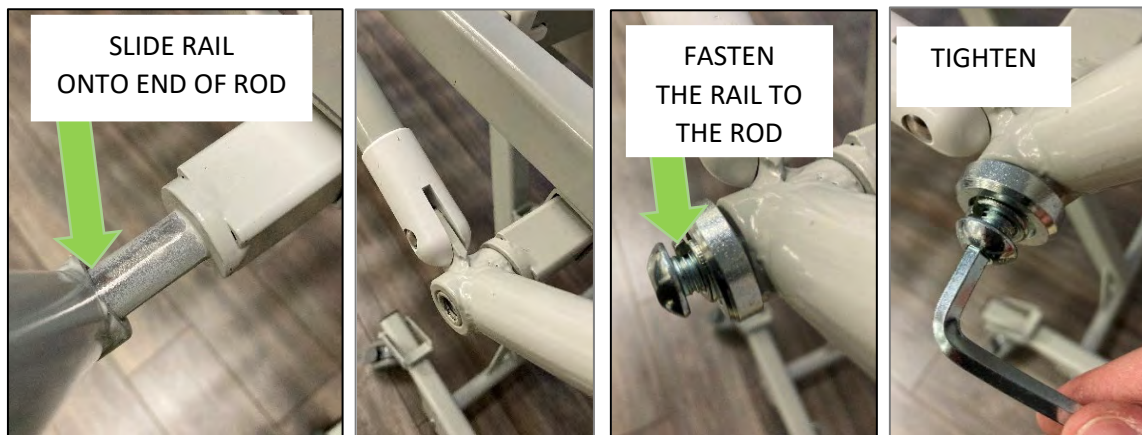

7 - Use a set screw to secure the foot end rod to a nut underneath the bed. Tighten using the Allen key provided.

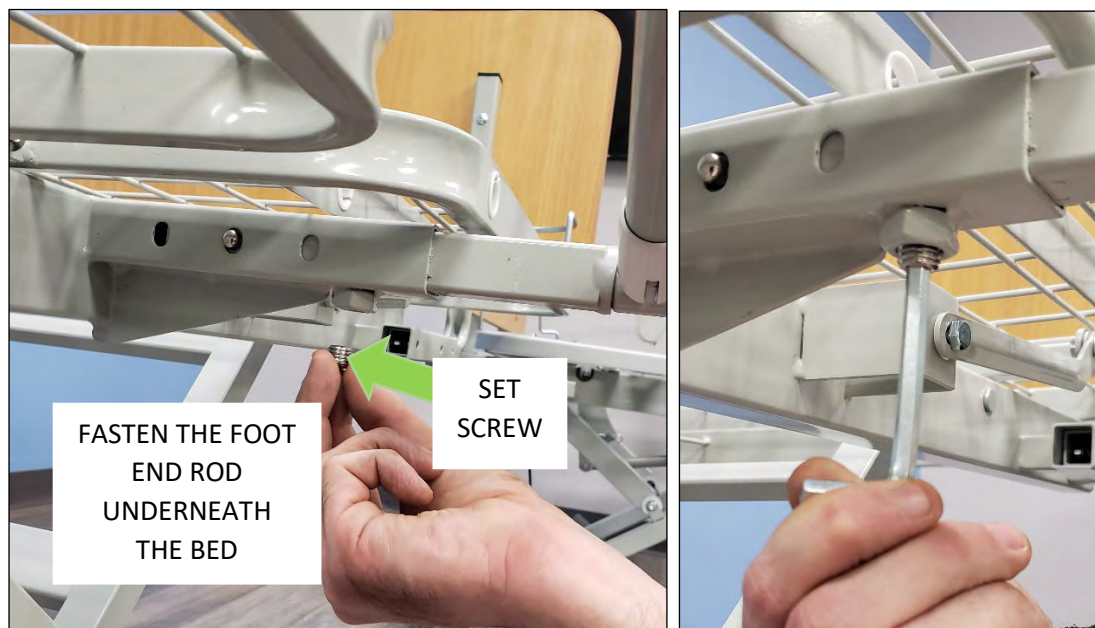

8 - Use a set screw to secure each head end rod to a nut on the bed. Tighten using the Allen key provided.



9 - Repeat for each end of each rail.

10 - To move the slide rail, pull the black knob under the head end to unpin it, and then slide the rail.





### 3.3 Install optional assist bar

**Tools required:** Allen key, small hammer

#### STEPS

- 1 - Open the assist bar box and remove the rail and hardware.



- 2 - Remove the packaging from the assist bar and hardware.  
Verify that you have 1 assist bar, 2 rods, 2 pins, and 2 screws.



3 - Adjust the bed to be flat.



4 - Use the screws to attach the rods to the inside of the assist bar.

5 - Feed each rod through both an outside and inside hole in the bed.

6 - Securely tighten the screw on the outside of the bar using a size 5 Allen key.

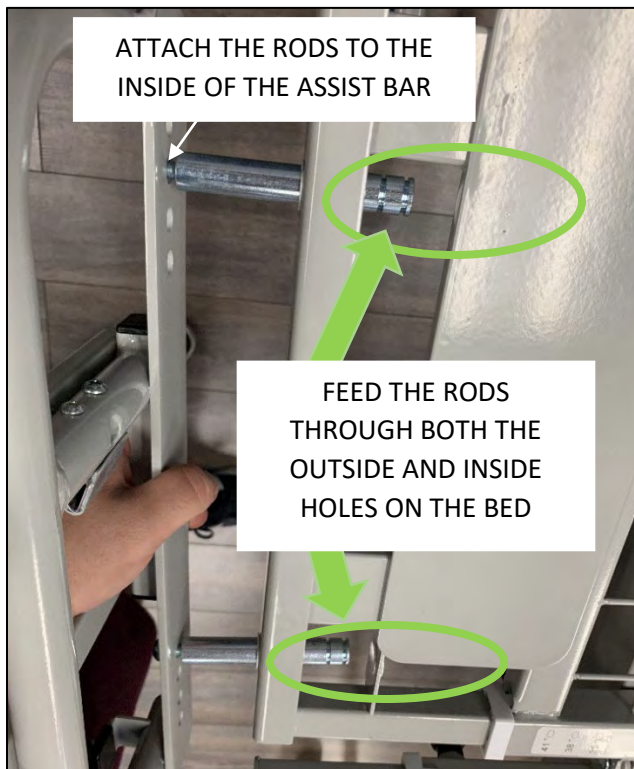

7 - Place a pin on each of the 2 grooves in each rod. Use a hammer to tap each pin into place.

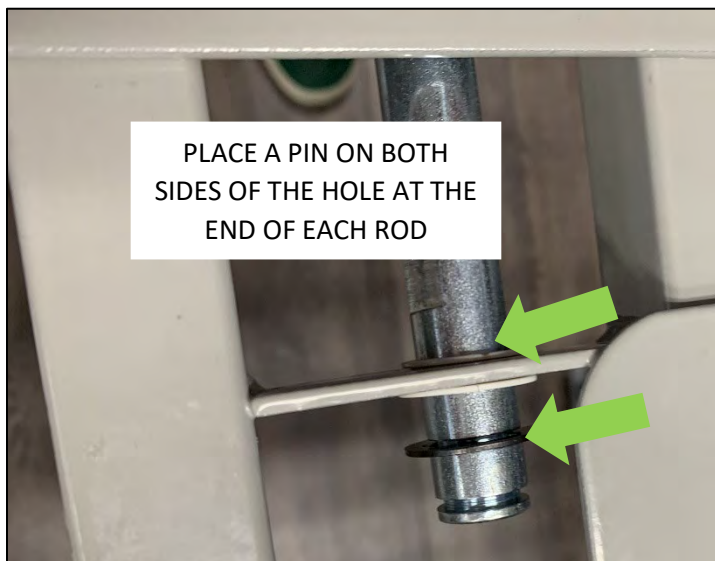

To move the assist bar, pull the knob out and then pull down on the black handle.

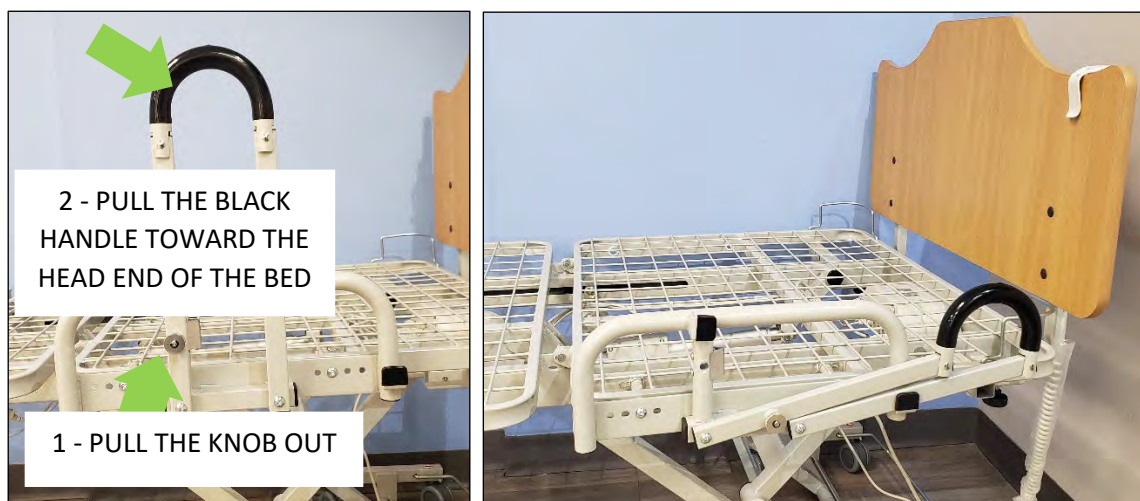



## 4 – Install the headboard and footboard

The headboard and footboard are shipped in one box. The hardware is in the hardware pack removed earlier.

### 4.1 Install the headboard and footboard

**Tool required:** Phillips head screwdriver

#### STEPS

- 1 - Open the head & footboard box and the hardware pack.



- 2 - Verify that you have a headboard (curved top), a footboard, 4 u-shaped supports, 4 mattress retainers (used later), and 4 screws.

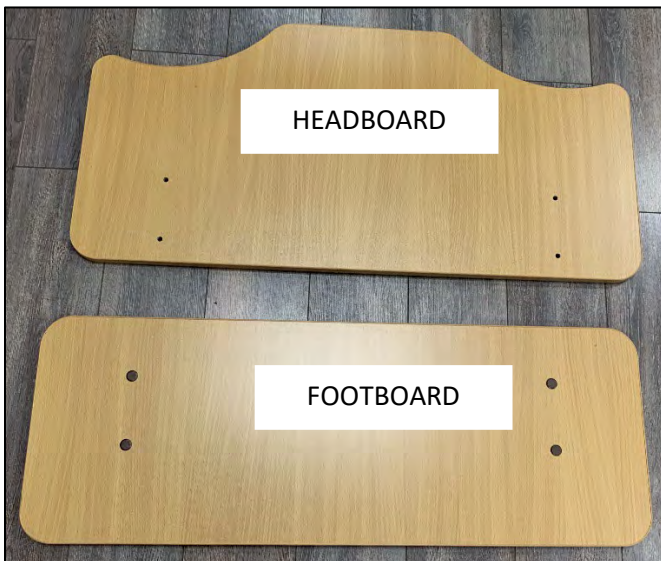

- 3 - Use the hand pendant to raise the bed.

4 - Unscrew the 2 black knobs on each end of the bed, 4 knobs total.

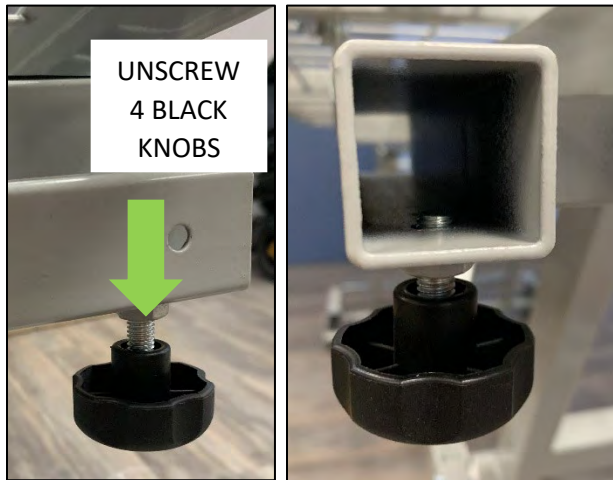

5 - Place a U-shaped bracket in each channel where you just removed a black knob. Press the button on the channel to slide the bracket in. Note that on the foot end you can leave extra space if you will be extending the bed platform length.

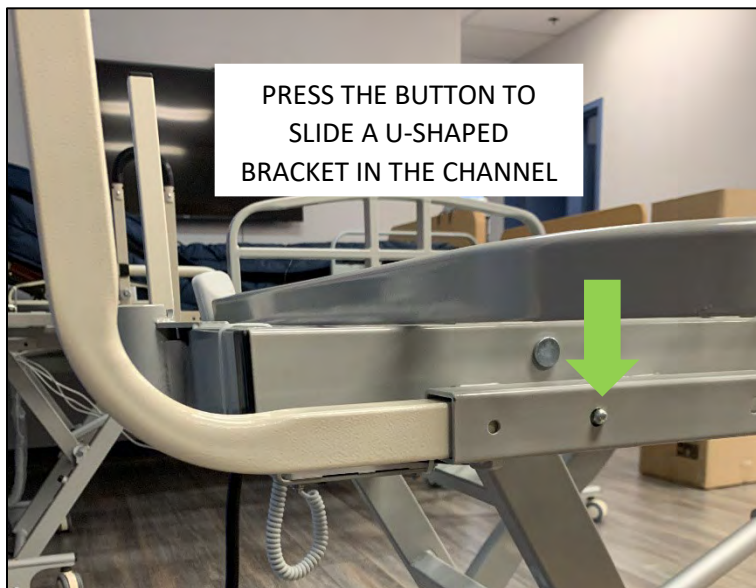

- 6 - Secure the headboard and footboard to the U-shaped brackets using the screws provided. Note that the brackets are on the outside of the headboard and on the inside of the footboard.

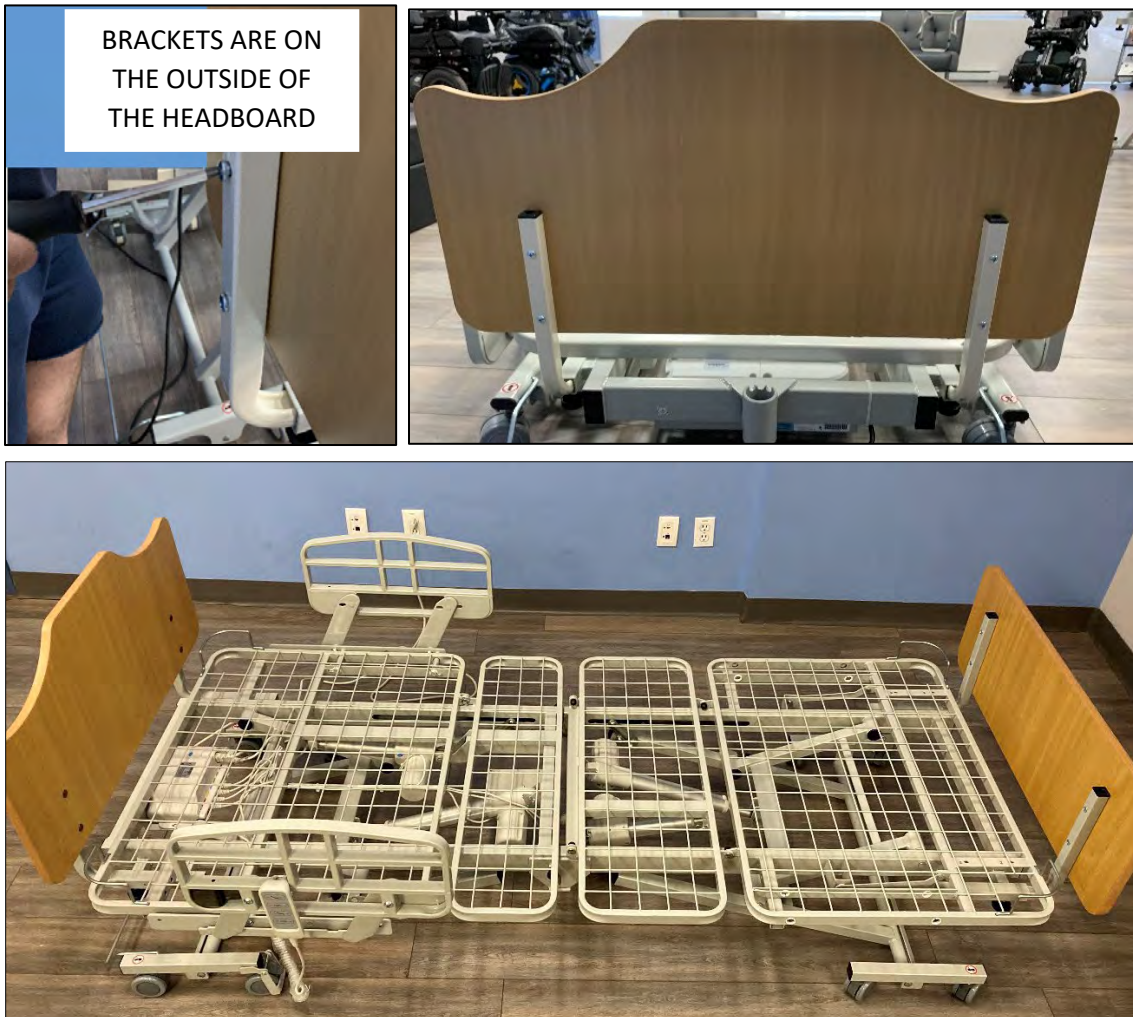



## 5 – Connect the optional staff controller

An optional staff controller can be used with your Tröst Lite Bed. The staff controller is shipped in a separate box.

The controller must be connected to the control box under the head end of the bed.

**Tools required:** screwdriver

### STEPS

- 1 - Unpack the staff controller



- 2 - Lift the platform at the head end of the bed to access the controller. Use a screwdriver to press in and lift to detach each end of the cord protector on the bed controller. Remove the cord protector.



3 - Connect the staff controller to the purple connection port on the bed controller.

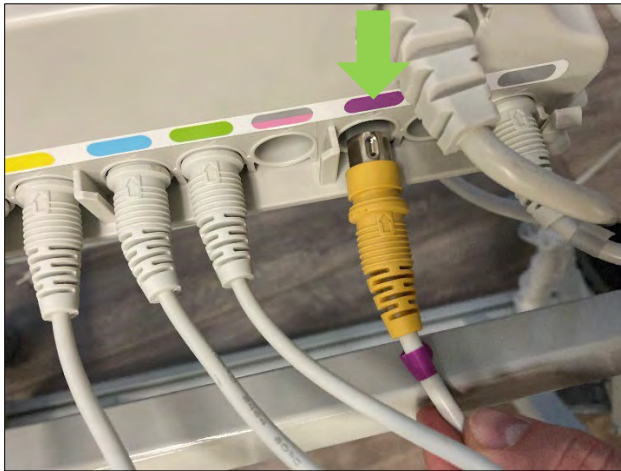

4 - Replace the cord protector on the bed controller.  
Press down so that it snaps into place.

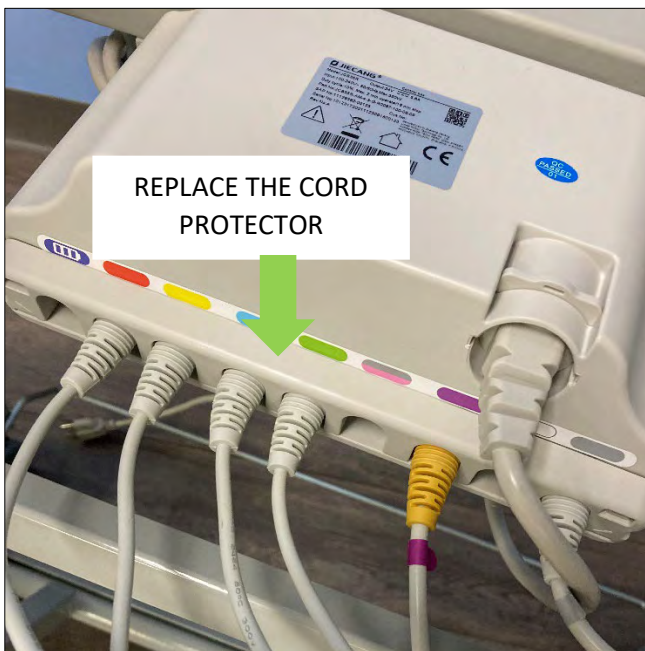



5 - Hang the staff controller on the footboard. Ensure that the cord is out of the way of the bed when it moves.



6 - Test the staff controller functions.

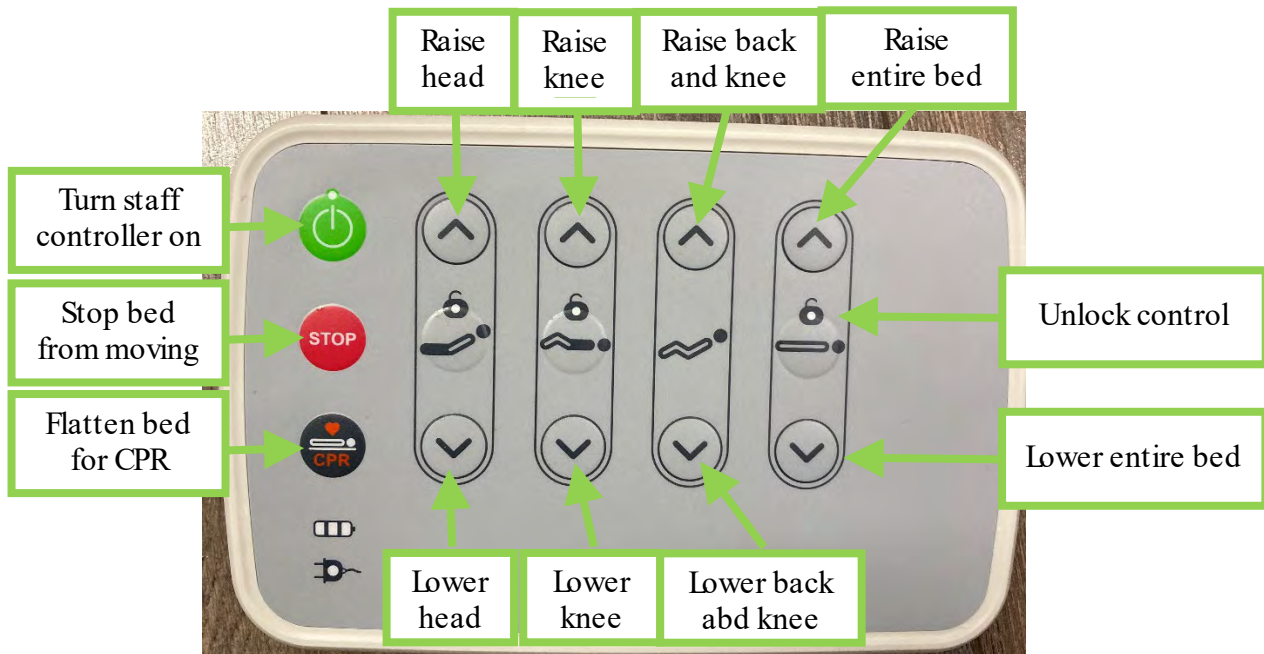

## 6 – Install the battery backup

An optional battery backup is available to provide power to the bed when the bed is temporarily unplugged or in the event of a power failure.

**Tools required:** Phillips screwdriver, grips

### STEPS

- 1 - Unpack the battery backup.
- 2 - Remove the cap from the connector, and remove the 4 screws from the mounting flange.



- 3 - Lift the platform at the head end of the bed to access the controller. Use a screwdriver to press in and lift to detach each end of the cord protector on the bed controller. Remove the cord protector.



- 4 - Connect the battery backup to the battery connection port on the bed controller.
- 5 - Replace the cord protector on the bed controller.  
Press down so that it snaps into place.

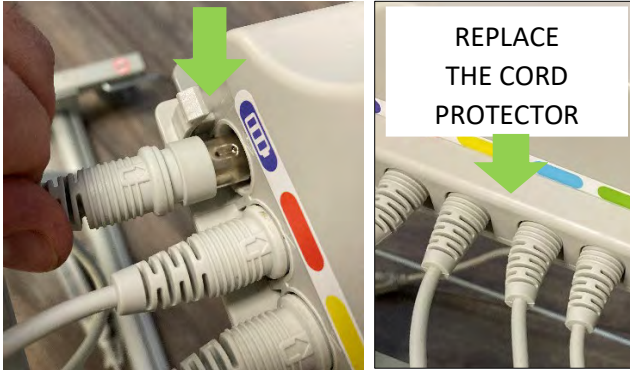

- 6 - Locate the battery backup mounting plate in the center of the head end of the bed platform.
- 7 - Place the battery backup on the mounting plate.

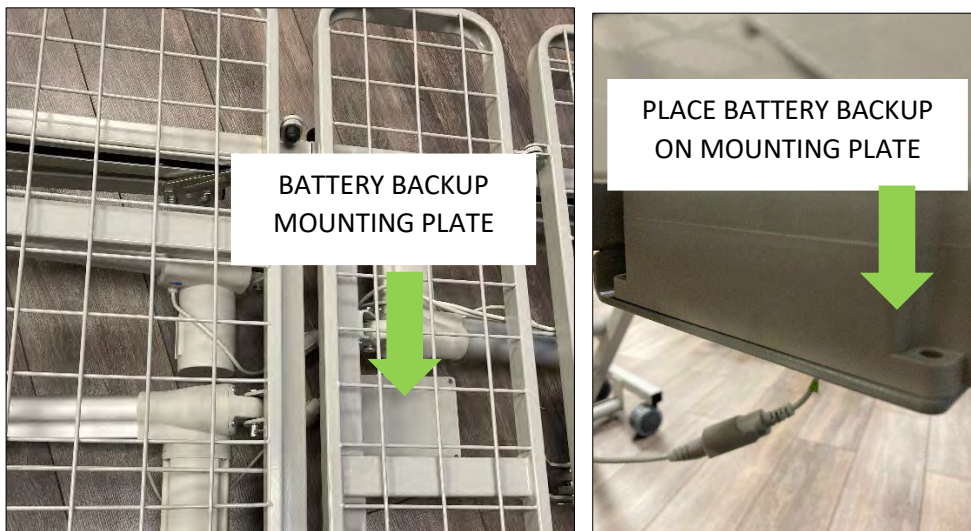



- 8 - Replace the 4 screws removed earlier to fasten the battery backup to the mounting plate.
- 9 - Tighten the 4 fasteners to securely hold the battery backup in place.

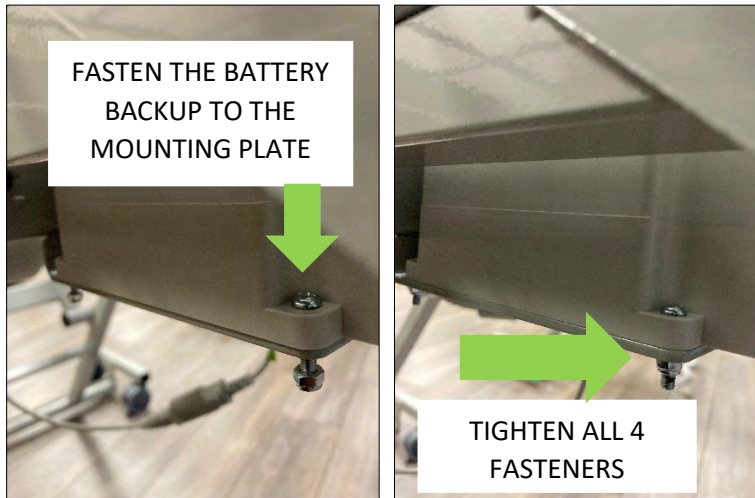

- 10 - Let the batteries charge for 48 hours before testing. To test, unplug the bed. The controller should stay illuminated and function when the bed is unplugged.

## 7 – Prepare the bed for use

The final steps in the assembly include the following:

- 7.1 Install the optional length extender
- 7.2 Install mattress retainers
- 7.2 Use the bumper
- 7.4 Use the wheel directional limiters

### 7.1 – Install the optional length extender

The optional length extender increases the length of the bed from 80" to 84" (203 cm to 213 cm) to accommodate a longer mattress (sold separately).

#### STEPS

- 1 - Unpack the length extender.
- 2 - Insert the length extender into the holes marked 84" on the foot end of the bed platform.
- 3 - Ensure that the extender is secure, and opens flat.





## 7.2 – Install mattress retainers

### STEPS

- 1 - Use the 4 mattress retainers from the hardware pack.



- 2 - Insert one mattress retainer in each of the 4 corners of the bed platform.

If you installed the length extender you will not use the mattress retainers on the foot end of the bed.



The mattress is sold separately from the Tröst Lite Bed. Place the bed in a flat position when installing the mattress. Be sure that any mattress used meets all applicable safety standards.

### 7.3 – Use the bumper bar

Use the hand pendant to raise the bed enough so that you have clearance to lower the bumper bar on the head end of the bed. Raise or lower the bar as needed.



### 7.4 – Use the wheel directional limiters

If you need to move the bed and want to ensure that the wheels only move straight back and forth, you can use the wheel directional limiters.

Simply flip each limiter over the wheel to ensure that the wheels don't turn from side to side. Note that the wheels will still move forward and backward.

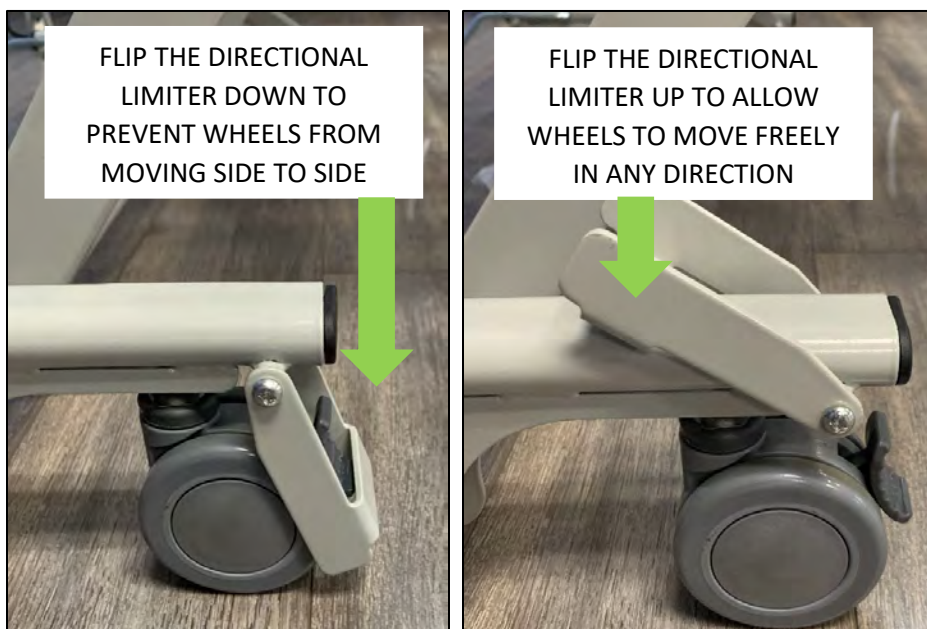

## Optional Transport Trolley Assembly

The Transport Trolley is sold separately and shipped in a separate box. The transport trolley is used to move the Tröst Lite Bed in a vertical or horizontal position.

### Assemble the transport trolley

**Tools required:** Cable tie snipper, 19 mm wrench

#### STEPS

- 1 - Unpack the Transport Trolley.

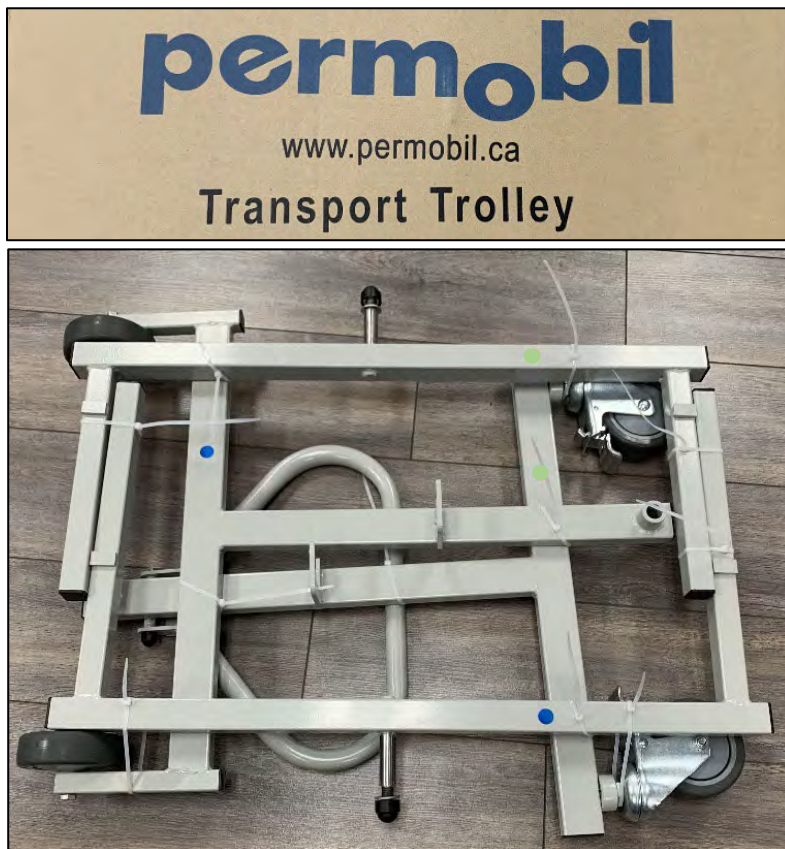



- 2 - Remove all 12 cable ties so that you can separate the trolley into 4 pieces: 2 supports and 2 wheel assemblies.



- 3 - Note that the pieces are color coded (2 pieces have blue dots, and 2 pieces have green dots). Start with the wheel assembly and support with the blue dots.

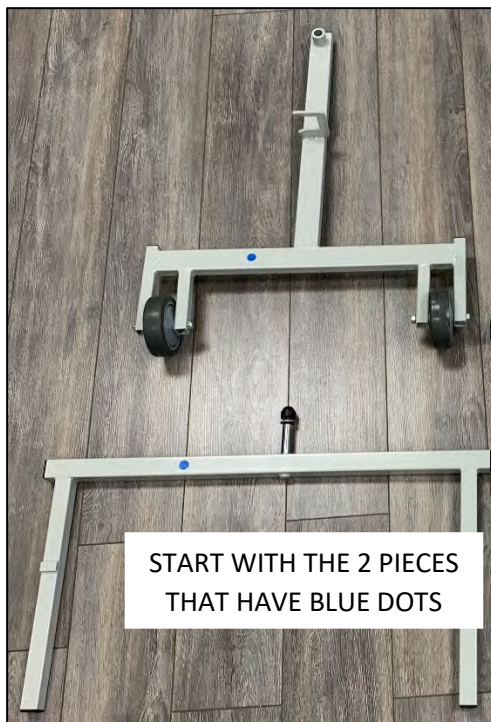



4 - Remove the black screw cover from the support. Feed the bolt on the support through the hole in the wheel assembly.

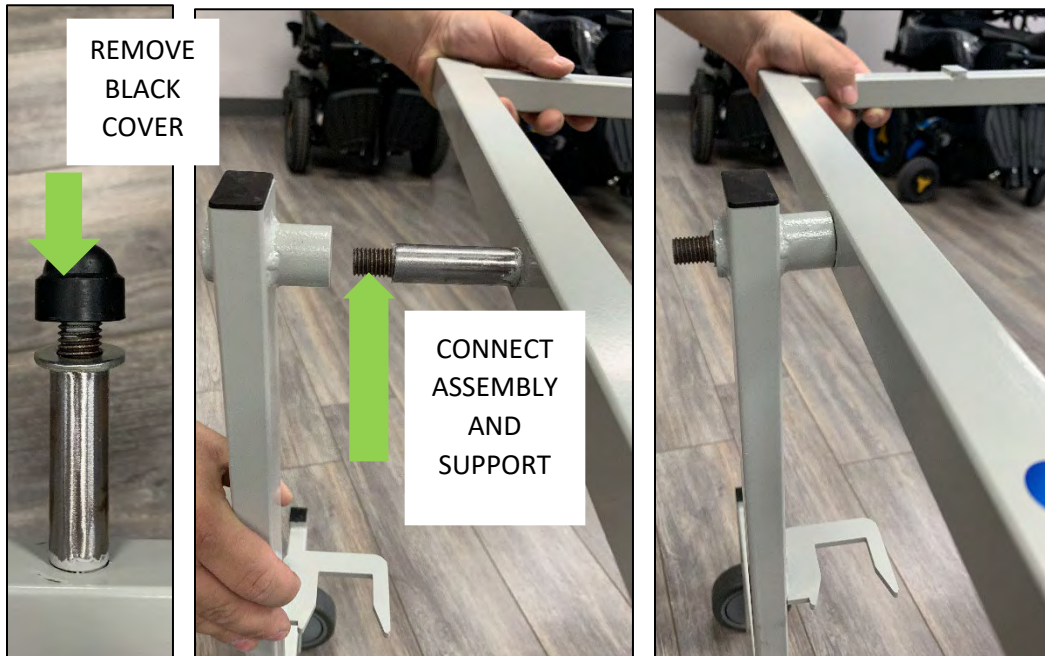

5 - Ensure that the support moves freely in and out of the hook on the wheel assembly.

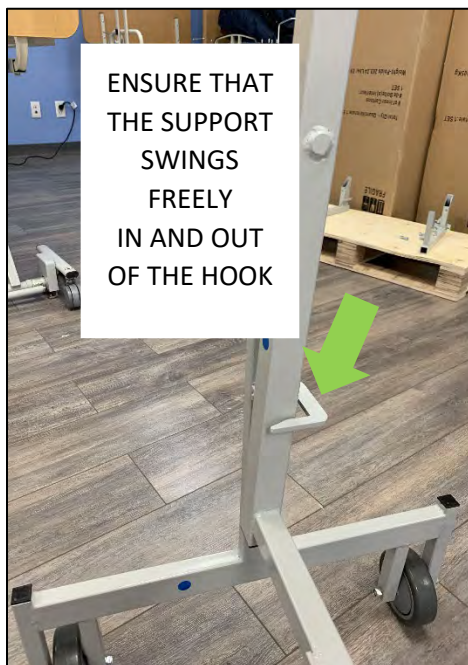

6 - Follow the same procedure to connect the 2 pieces with green color-coded dots.



7 - Secure each bracket to each wheel assembly with a washer and nut. Tighten securely.



8 - Replace the black covers.



Note that the finished Transport Trolley is in 2 pieces: one piece for the head of the bed (green color-coded dots), and one piece for the foot of the bed (blue color-coded dots).

## Use the transport trolley

The transport trolley can be used to move the Tröst Lite Bed in a horizontal or vertical position. To use the transport trolley, the headboard and footboard must first be removed from the bed. The head end of the trolley is used on the head end of the bed, and the foot end of the trolley is used on the foot end of the bed.

### STEPS

- 1 - Remove the headboard and footboard by sliding the U-shaped brackets out of the channels on the bed support.

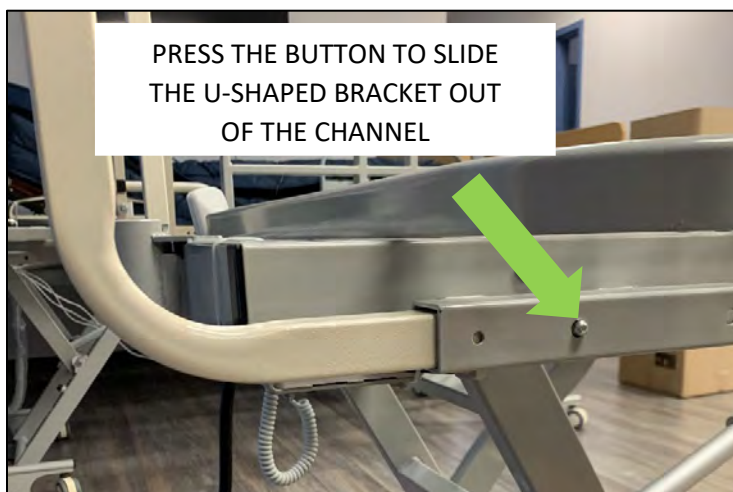



- 2 - Adjust the height of the bed so you can slide the trolley support brackets into the channels on the ends of the bed support. Green = head, blue = foot. Ensure that the raised parts of the trolley supports are facing up.

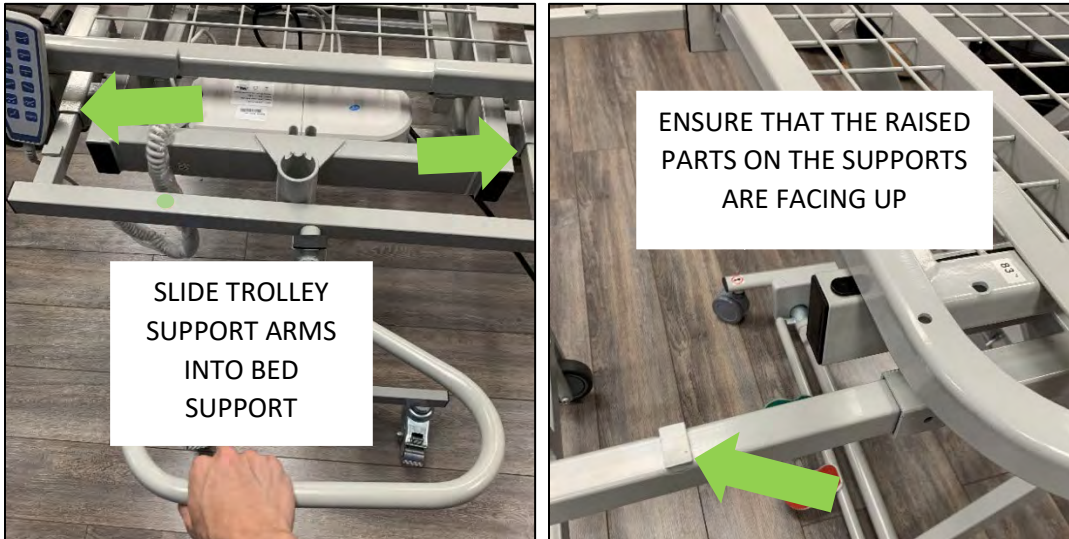

- 3 - Slide the trolley support arms in completely until the raised part of the bracket is against the bed support.



- 4 - Lower the bed so the wheels are off the floor.
- 5 - Unplug the bed power cord.



6 - You can use the trolley to move the bed horizontally or you can rotate the trolley supports to move the bed vertically. Ensure that all wires are safely out of the way.



7 - Use the trolley handle to move the bed.

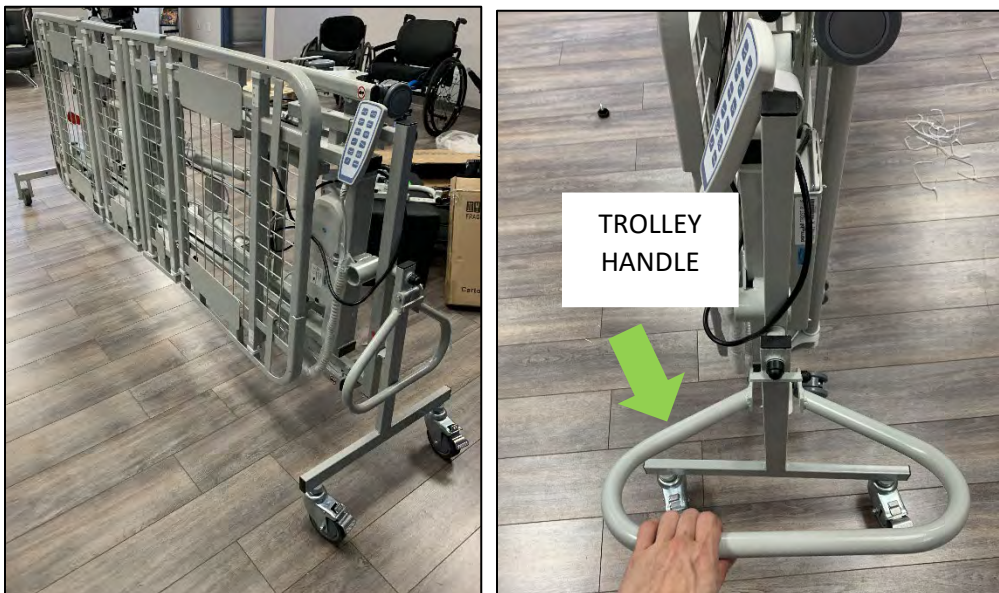

# BedUsage

## Inspect the bed before use

- ✓ Visually check the bed and its accessories. Ensure that no wires are exposed.
- ✓ Verify that all attaching hardware is securely tightened.
- ✓ Make sure the power cable cannot get damaged to avoid injuries and/or equipment failure.
- ✓ Check the headboard and footboard to be sure that they are secure and that all screws have caps securely in place.
- ✓ Verify the functioning of all side rails.
- ✓ Apply the brakes on the casters and ensure that they function properly.
- ✓ Use the hand pendant to check all positions of the bed (see next section).
- ✓ When applicable for battery backup testing:  
After the bed has been plugged in for at least 48 continuous hours, unplug the power cord and test the battery backup by using the hand pendant.



## Move the bed into different positions



Before moving the bed into a different position, ensure that nothing will interfere with the movement of the bed.

Use the hand pendant to move the bed into different positions. In general, the buttons on the left raise, and the buttons on the right lower each section of the bed.

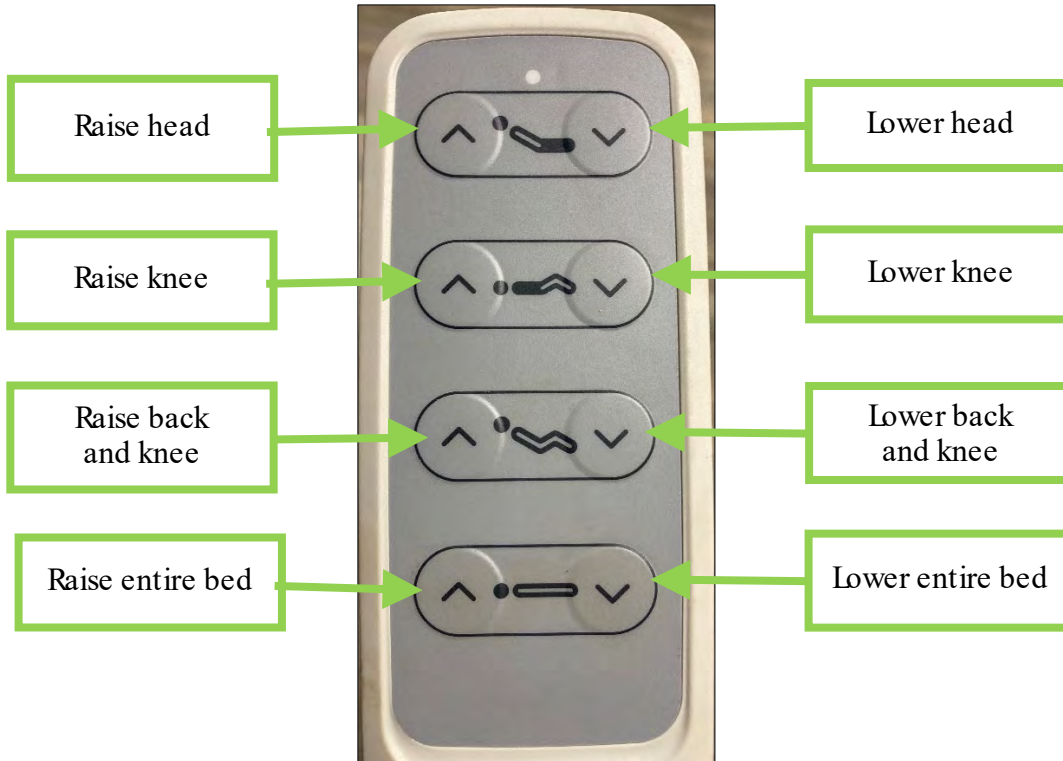

## Safe operation

### Moving the bed

To reduce the risk of injuries when moving the bed with a person laying in it, always put the bed at its lowest position, then place the platform horizontally and leave the side rails raised.

Always apply the brakes after moving the bed, and before a person sits or lies down on the bed. Check the bed to make sure the brakes have been applied.



## Using side rails

Side rails are made to prevent accidental falls. They must not be used to restrain, to keep the user from getting out of the bed, or to help the user to turn. It is the caretaker's responsibility to use the appropriate restraining means for the user's safety.

Half side rails at the head of the bed should always be up when repositioning the bed.

When the side rails are up, make sure that they are properly locked. Half side rails at the head of the bed should always be up when moving the bed.

It is the responsibility of the user and his or her healthcare professional to determine whether the half side rails at the foot end of the bed should be left up or down, so that the user can get out of the bed at their convenience.

## User safety

Unless otherwise medically advised by a professional, lower the bed to the lowest horizontal position and leave side rails up and locked when the user is sleeping or left without supervision.

If required for the user's welfare or security, unplug the remote.

## Electrical safety

Unplug the bed immediately if a significant overflow of liquid is accidentally spilled on the electronic components, the wires, or the electric motors. The functioning of these components can be affected. The user must be removed, the bed cleaned and examined by a qualified technician. The bed can be used again only if it has been properly cleaned and examined.

No electrical components should be changed by anyone other than a qualified technician. Before changing an electric component, unplug the power cable and the battery fuse. This must be done by a qualified technician.

## Maintenance

Regular maintenance is essential to maintain the bed's reliability. A defective bed should not be used. Make sure to support the frame of the bed if you need to work under the platform. This will prevent the bed's structure from falling accidentally. If a moving part needs to be re-lubricated, use any piston lube.

### Cleaning

Always unplug the bed before cleaning.

Do not submerge the hand pendant in liquid. Do not steam or pressure wash the bed or any of its components. Never use high pressure water, or ultrasounds, and never submerge the bed parts to clean them.

To clean the bed, use detergents normally used in hospitals or at home. Products may be applied by lightly spraying or wiping. **Excess water or liquid may damage electrical parts and pose a shock hazard.** Make sure the cleaned parts are dry before using the bed again.

Do not remove lubricant from the moving parts of the bed.

### Regular inspection

- Visually check the bed and its accessories. Ensure that no wires are exposed.
- Make sure the power cable cannot get damaged to avoid injuries and/or equipment failure. Check all cords for cuts or damage.
- Check the headboard and footboard to be sure that they are secure and that all screws have caps securely in place.
- Verify the functioning of all side rails.
- Apply the brakes on the casters and ensure that they function properly.
- Use the hand pendant to check all positions of the bed.
- Visually examine all welds for cracks.
- Inspect all bed components for damage or excessive wear.
- Inspect the deck components for bending or damage.
- Inspect all bolts and fasteners.

When applicable for battery backup testing:

After the bed has been plugged in for at least 48 continuous hours, unplug the power cord and test the battery backup by using the hand pendant.

All defects must be repaired immediately by a qualified and authorized technician. Only use Permobil replacement parts.

## Troubleshooting

Problem	Possible cause(s)	Solution(s)
None of the functions work	Hand pendant	<ul style="list-style-type: none"> <li>• Plug in the hand pendant.</li> <li>• Reset the hand pendant by holding both buttons on the second row (raise and lower foot) at the same time for 6-8 seconds.</li> <li>• Try another hand pendant from a working bed.</li> </ul>
None of the functions work or Functions work, but the bed moves slowly	Power	<ul style="list-style-type: none"> <li>• Plug the bed into a wall outlet.</li> <li>• If the power outlet is on a switch, turn the switch on.</li> <li>• Check the fuse box.</li> <li>• Try another wall outlet.</li> <li>• Verify that the power source (outlet) is adequate for the bed electrical rating.</li> </ul>
	Power cord	<ul style="list-style-type: none"> <li>• Insert the power cord fully into the electrical controller system.</li> <li>• Check the power cord for damage; replace the power cord if damaged.</li> </ul>
	Electrical connections	<ul style="list-style-type: none"> <li>• Verify that the electrical connections under the bed are properly connected.</li> </ul>
Motors are not functioning	Synchronization issue	<ul style="list-style-type: none"> <li>• Move the bed all the way down and keep holding the down button for 3 seconds.</li> </ul>
One of the motors makes a grinding noise	Gear is stripped	<ul style="list-style-type: none"> <li>• Replace the motor.</li> </ul>



## Troubleshooting (continued)

Problem	Possible cause(s)	Solution(s)
One of the motors is not functioning	Hand pendant	<ul style="list-style-type: none"> <li>• Try another hand pendant from a working bed.</li> </ul>
	Motor	<ul style="list-style-type: none"> <li>• Move the connector to another working port on the electrical controller system; if this doesn't work, replace the motor.</li> </ul>
	Damaged electrical connector wires	<ul style="list-style-type: none"> <li>• Check the electrical connector wires for damage; replace any damaged wires.</li> </ul>
	Connection to electrical controller system	<ul style="list-style-type: none"> <li>• Verify that the connector is pushed firmly into the electrical controller system.</li> <li>• Move the connector to another port on the electrical controller system.</li> </ul>
Motors work but the wrong movement occurs	Incorrect connection to ports on electrical controller system	<ul style="list-style-type: none"> <li>• Verify that each connector is in the correct port on the electrical controller system; if this does not solve the problem, replace the electrical controller system.</li> </ul>
Bed is not level when operating raise and lower functions	Uneven load distribution	<ul style="list-style-type: none"> <li>• Raise or lower the bed to its maximum or minimum height</li> </ul>

## Warranty

The Tröst Lite Bed is guaranteed against manufacturing defects according to these warranty periods starting from the shipment date:

Frame ..... 10 years

Electrical components ..... 2 years

Mechanical components..... 4 years

Head and Foot Boards..... 1 year

The bed is warranted to be free from defects in material and workmanship under normal use and service for the warranty periods specified.

Permobil reserves the right to substitute equal or superior quality materials during repairs and/or replacements. All repaired or replaced parts are guaranteed for whichever is greater: 1 year from the date of service or the life of the warranty.

This warranty does not cover damages caused by negligence or inappropriate use. Permobil will not be held responsible for any other warranty offered by any person, firm or company, to the exclusion of the one stipulated above.

This warranty gives you specific legal use rights and is only valid for the original purchaser.

## Returns

Returned goods require an RA number and are subject to a 25% restocking fee. Furthermore, the customer must pay the transport charges. For more information, please contact Permobil customer service, 1-800-265-9830.